

# VipWing



# Table of contents

8	Hospitality	Separate entrance, personal reception
10	Time-saving	Checks and shuttles – uncomplicated and screened
14	Indulgence	Fresh and refined, international and Bavarian
18	Comfort	Elegant lounges and exclusive atmosphere
22	Work	Space for contemplation and communication
24	Freshness	Luxurious bathrooms for a relaxed layover
26	Retreat	Enjoy peace and quiet
30	Privacy	Elegant suites for families, friends and business partners
40	Floor plan	
42	Travel directions & information	



A photograph of a modern architectural entrance at dusk. A covered walkway with a metallic ceiling and angled support columns leads towards a brightly lit glass entrance. The ground is paved with light-colored tiles, and there are patches of green grass on either side. On the left, a metallic wall features the 'VipWing' logo. On the right, there are large, white, curved sculptural elements. The sky is a deep blue, and the overall atmosphere is warm and inviting.

# /Welcome

VipWing



# /Welcome to VipWing

On an area of 1,700 square meters, the VipWing Terminal combines absolute functionality with timeless elegance. This lounge landscape flooded with light provides guests with tailor-made solutions to meet their individual requirements. Comfortable suites are available in which visitors can relax and work as the mood takes them. Culinary delights are served in the inviting buffet and bar area. It has its own beer garden which also offers a range of Bavarian specialities. Getting to and from the aircraft is as comfortable as it is convenient for passengers: all guests are chauffeured between VipWing and aircraft in luxurious limousines.

The pleasant and modern rooms of our VipWing Terminal subtly combine exclusivity and a cosmopolitan air with Bavarian local color. The aspiration of Munich Airport to be a representative gateway to Bavaria for guests from all corners of the world is convincingly underlined in the VipWing.

We are delighted to welcome and pamper you in our VipWing the next time you stay at Munich Airport.







## Individual access, personal VIP assistant

### Arrival made easy

A very pleasant aspect of the VipWing experience is the separate landside access. Without sparing a moment's thought for where to park, just pull in and get out. Fully protected from the elements, you'll enter the spacious entrance area of VipWing just a few steps away.

### Personal service

That's what sets VipWing apart from many VIP lounges around the world: You'll be met by your personal VIP assistant as soon as you pull up to the curb. He – or she – speaks several languages and will provide discrete and efficient assistance to meet your every need until your flight departs.







## Screening, shuttle

### Exclusive in every sense

Check-in formalities, baggage, passport control, and even customs, including VAT refunds: it's all handled quickly for you right inside VipWing. Security screening is also handled simply and discretely in a separate area. A special highlight is the exclusive VIP shuttle to and from your flight.









## Bar, buffet, dining

### Fresh and delectable

Over the course of the day, the buffet offerings range from a tasty breakfast or seasonal Bavarian delicacies to international dishes and fine cakes and pastries. At the centrally located bar, the team of baristas are waiting to prepare popular coffee concoctions and also offer a selection of aromatic teas and selected regional and international wines. Rounding off the bar menu are world-famous Bavarian beers and an extensive list of cocktails.







## Traditional and classy

### Under Bavarian skies

Enjoy your stay with a visit to our relaxed beer garden to enjoy fresh beer on tap and tasty regional cuisine while taking in the panorama of the Bavarian Alps in the distance.

### Exquisite enjoyment

For guests with a passion for tobacco, an elegant smoking suite is situated at the heart of the VipWing lounge facility.







# Lounges

**Fully relaxed**  
Settle into the spacious rooms of VipWing for some restful downtime. The comfortable lounges, each with individual decor, are an inviting spot to while away your waiting time, enjoying the unique objets d’art and designer furnishings or taking in a spectacular view of the airport scenery.









# Working

## Ideal for keeping your focus

Quiet work stations and suites provide ideal conditions for using your time efficiently. For meetings with even more privacy or in larger groups, the conference suite «Schleissheim Castle», equipped with complete conference technology, is the perfect choice.







## Showers, etc

### Freshen up – the relaxed way

What could be more pleasant than a hot shower after a long flight? Our luxurious bathrooms offer all you need for freshening up or changing your outfit when waiting to catch a connecting flight or on arrival. Treat yourself to that new-born feeling!



# Rooms to relax in

**Where mind and spirit can unwind**

Take an easy stroll while enjoying the wide-open view – towards the Alps, or retreat to «Herrenchiemsee Castle», our relaxation suite designed in the style of a mountain chalet. A prayer room is available to visitors of all denominations for moments of quiet reflection.











# Suite Linderhof Castle

The suite «Linderhof Castle» is an oasis of calm. With a total area of 41 sq.m. [approx. 425 sq.ft.], it offers sumptuous surroundings for secluded relaxation, including a spacious bathroom with a rain shower. A flatscreen satellite TV and WIFI access let you maintain contact with the outside world while enjoying quiet privacy.

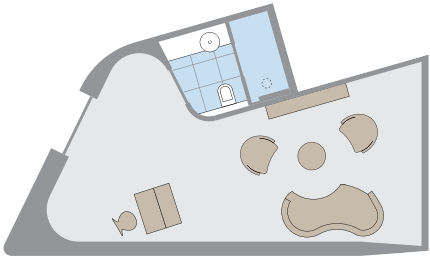





# Suite Nymphenburg Castle

The suite «Nymphenburg Castle», with an area of 40 sq.m. [approx. 420 sq.ft.], offers the regal comfort its name suggests. Everything is geared to maximum comfort, convenience and enjoyment, from the sumptuous queen-size sleeping nook and the flat screen satellite TV, to WIFI access for undisturbed work.

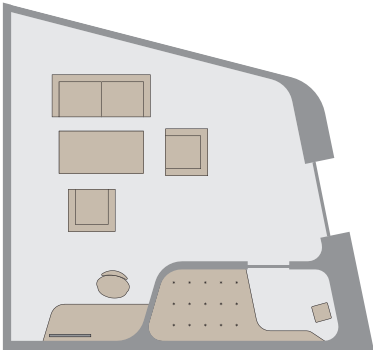



# Suite Schleissheim Castle

This conference room, with an area of 35 sq.m. [approx. 370 sq.ft.] leaves nothing to be desired – either in terms of equipment or ambience. With an electric projection screen, a TV-enabled HD projector with more than 100 channels, sound system, sideboard with integrated minibar and a coffee station, it offers top-rate conference facilities. When combined with the suite «Neuschwanstein Castle», it becomes a meeting space with a conference room and adjoining break area.

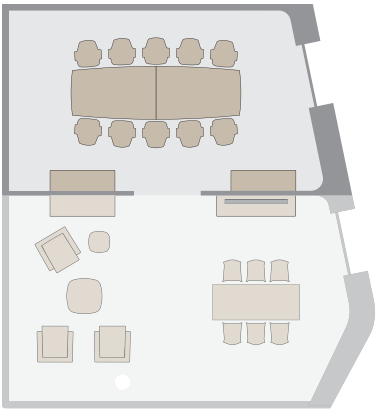





# Suite Neuschwanstein Castle

The suite «Neuschwanstein Castle», generously proportioned with an area of 44 sq.m. [approx 475 sq.ft.], functions as a spacious living room with its own dining table, or as an elegant, modestly scaled meeting room. When combined with the suite «Schleissheim Castle», it becomes a meeting space with a conference room and adjoining break area. The suite comes equipped with a flat screen satellite TV and a minibar integrated into the sideboard.

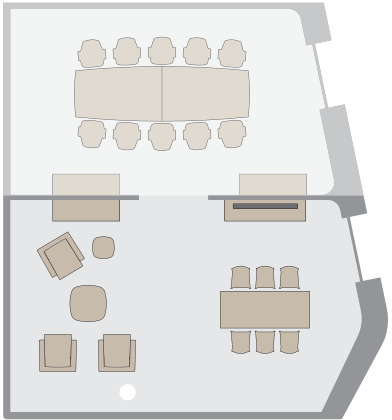











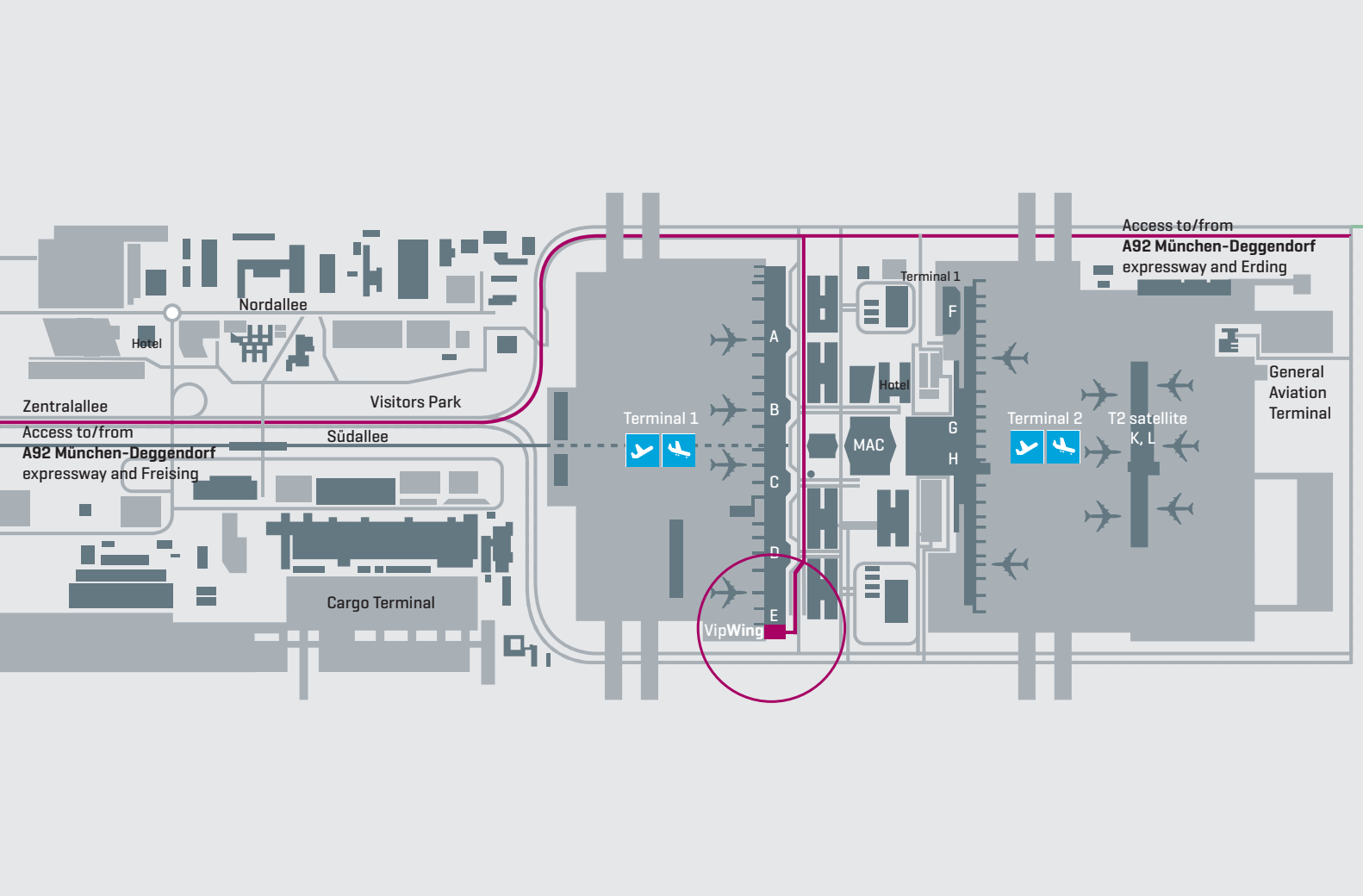

# Directions

- Munich Airport**
- Terminal 1
  - Access via Module E





# Contact

Flughafen München GmbH  
VIP Services  
Telephone +49 89 975 213 33  
Fax +49 89 975 213 36  
E-Mail: [vipwing@munich-airport.de](mailto:vipwing@munich-airport.de)  
[www.munich-airport.com/en\\_vip](http://www.munich-airport.com/en_vip)

# Imprint

Editor:  
Flughafen München GmbH  
VIP Services  
P. O. Box 23 17 55  
85326 München

Concept:  
Ludwig Krämer  
Martin Rathgens  
VipWing

Pictures:  
Diar Nedamaldeen  
Michael Berninger  
Michael Kammeter  
Bernd Dücke

Editorial office:  
Corporate Media

Design:  
parole GmbH München

Printing:  
G. Peschke Druckerei GmbH

